

Adjustable

FRETBENDER

This is an instruction on how to build your own fretbender.
All parts should be easily available at your local hardware store.

You will need a bit of mechanical skill, some good drills for wood, a hacksaw, a good wood saw (a buzz saw would be perfect) and a sharp pencil to mark the drill positions.

With this fretbender you can band or even overbend the fret wire a little, which makes the frets a perfect seat even at the fingerboard edges.

Take a plastic hammer and beat the frets down starting from both edges and let the middle part follow. So the edge teeth at the fret tang can grab sideways into the wood when the mid part is beaten down and in consequence you will avoid raised fret ends at the fretboard edge.

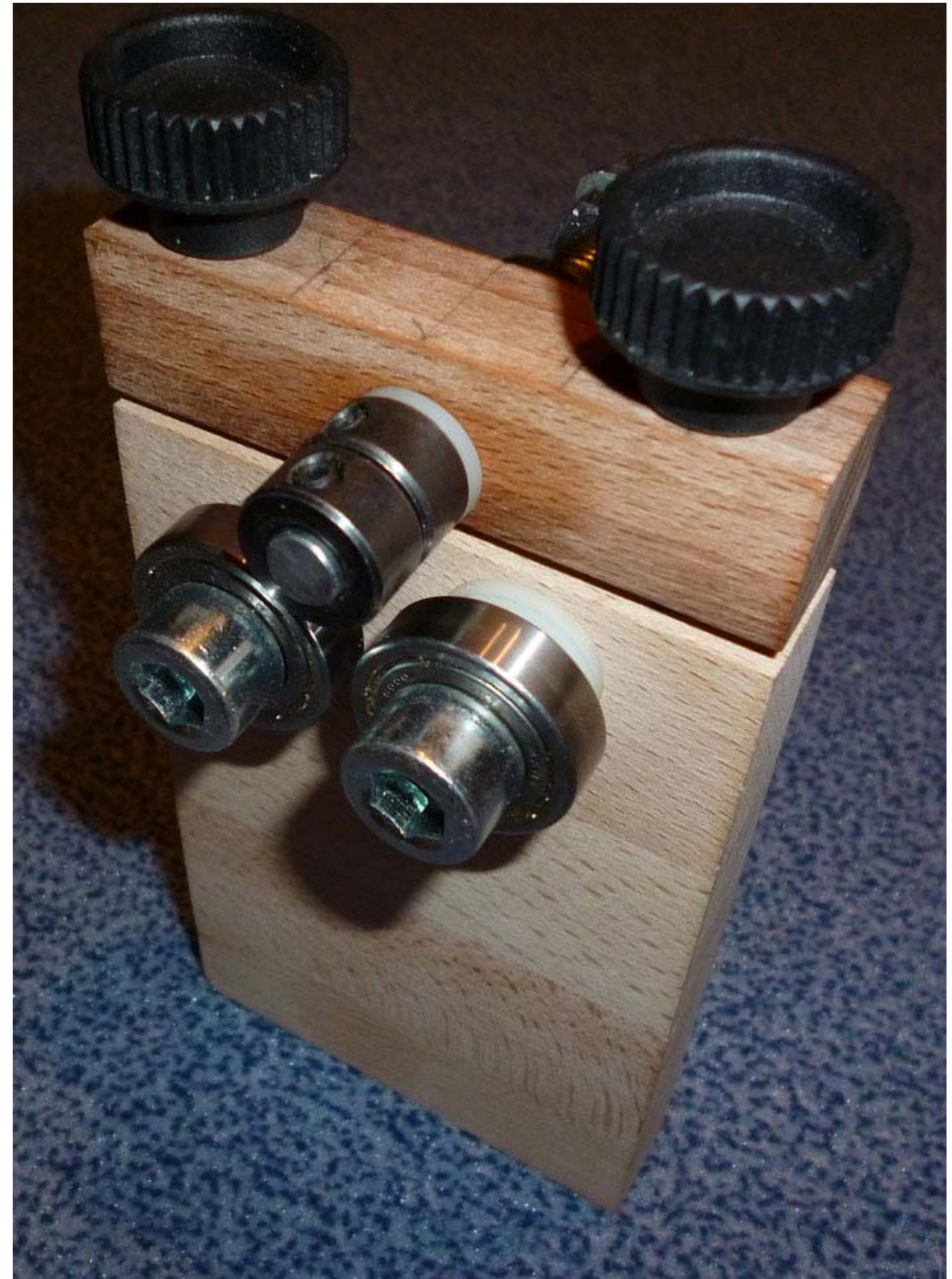

The things you'll need!

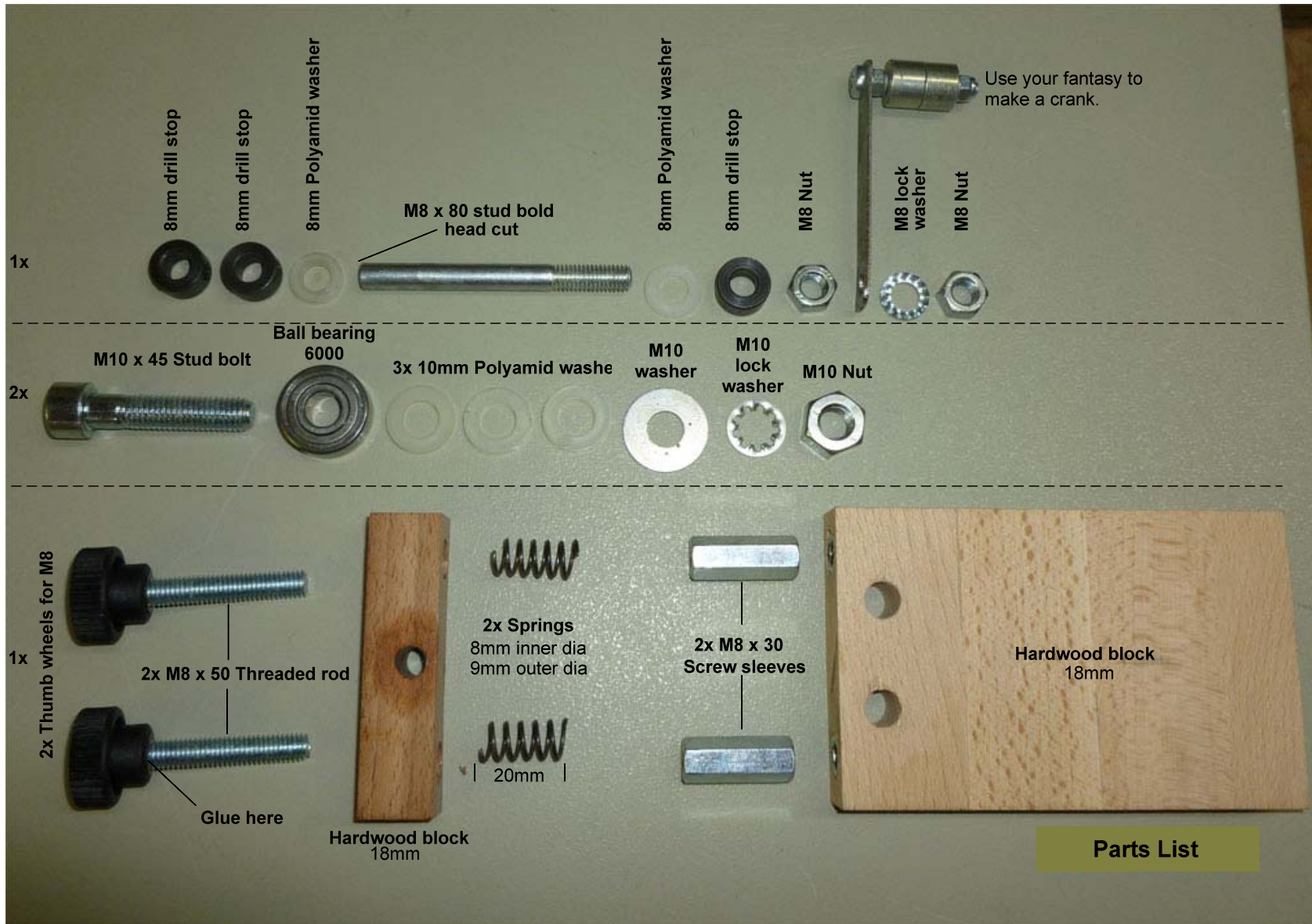

Änderungen		Datum	Name	Bezeichnung: MyFretbender Parts List	Blattzahl:
Datum	Name	gez.:			
		gepr.:			Blatt-Nr.:
		Bernd Brieskorn (2013) All measures in [mm].		Zeichnungs-Nr.:	2

1

2

3

4

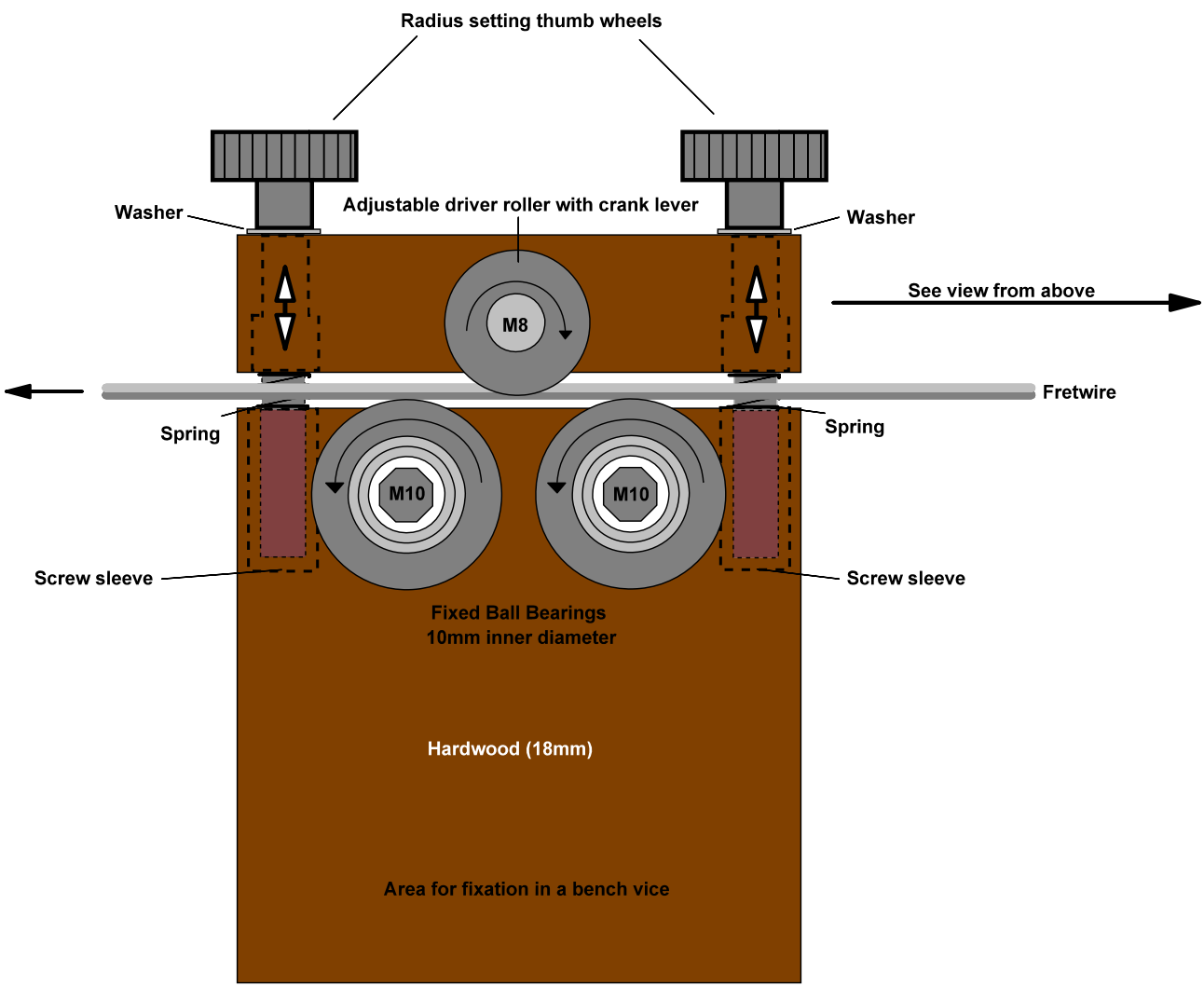

See view from above →

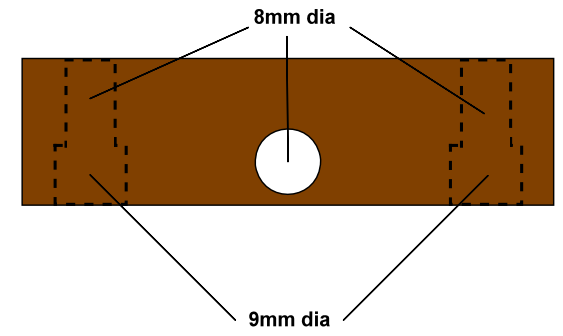
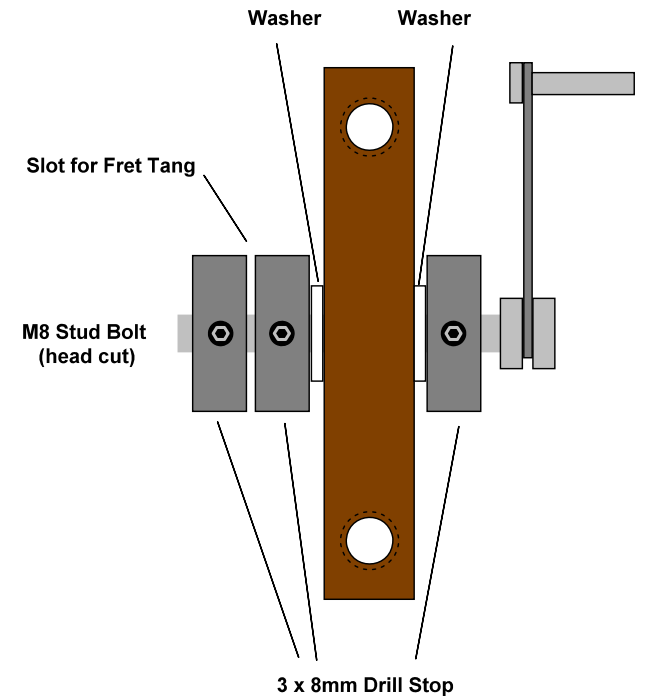

(9mm dia if springs have a 9mm outer diameter)
 This is to give the springs room to compress and to allow the variable bar go in touch with the main block.

Änderungen		Datum	Name	Bezeichnung: MyFretbender Principle	Blattzahl:
Datum	Name	gez.:			
		gepr.:			Blatt-Nr.:
		Bernd Brieskorn (2013) All measures in [mm].		Zeichnungs-Nr.:	3

A

B

C

D

E

F

1

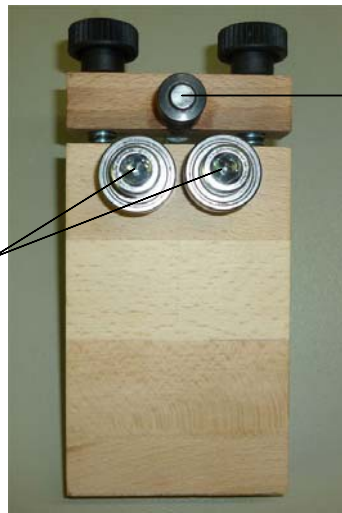

It is recommended to drill the two 8mm holes for the fret radius adjustment before cutting the wood into two pieces. So the holes will be perfectly in line afterwards. Then enhance the holes in the basis block to 11mm for the screw sleeves to fit in (pressed).

Here the two ball bearings (Standard 6000) are mounted by means of the M8 bolts as well as the drive shaft with the two drill stops. The blank part is the cut face of the stud bolt, which had lost its head.

2

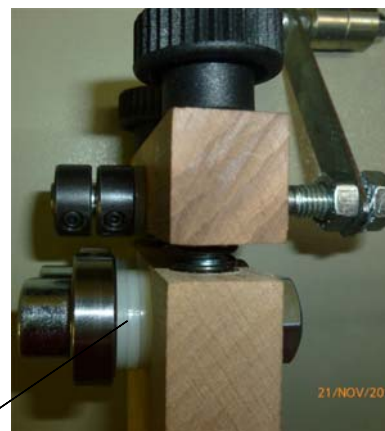

Detailed view on the "action side". You can see the 3 polyamid washers adjusting the ball bearings to sit in the middle of the 2 drillstops.



Detailed view from the crank side.

3

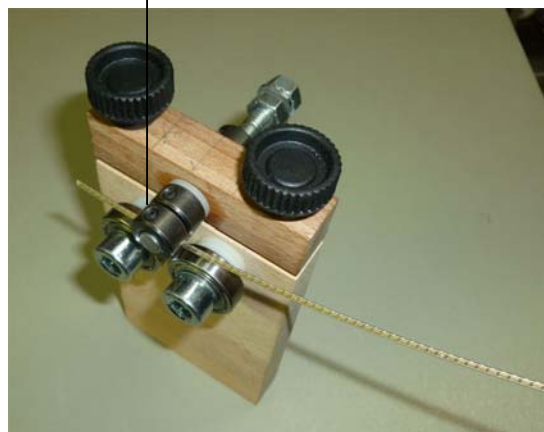

By adjusting the outer drill stop you can easily adjust the slot to fit the fret tang thickness.



Here you can see how the screw sleeves are pressed into the holes. Drilling with 11.5 mm is enough to fix the sleeve tightly by pressing in.

4

**Think of your health!
Always wear safety glasses and fix the workpiece tightly
while drilling and sawing.**

Änderungen		Datum	Name	Bezeichnung: MyFretbender Pictures	Blattzahl:
Datum	Name	gez.:			
		gepr.:			Blatt-Nr.:
		Bernd Brieskorn (2013)		Zeichnungs-Nr.:	4

A

B

C

D

E

F

1

A

B

AB

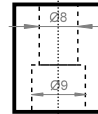
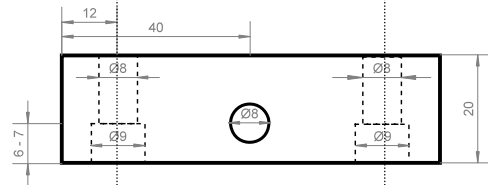

It is recommended to cut a piece of hardwood first (80 x 125+20"size of saw blade") and drill of the two 8mm dia holes A and B (~80mm deep).

Then cut the smaller piece away so it becomes 20mm in height.

By this you are sure that the holes fall in line perfectly. You can then drill down the 11.5 mm part to place the M8 screw sleeves.

2

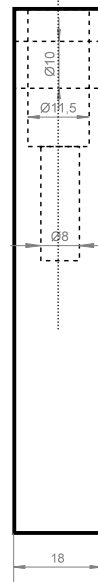
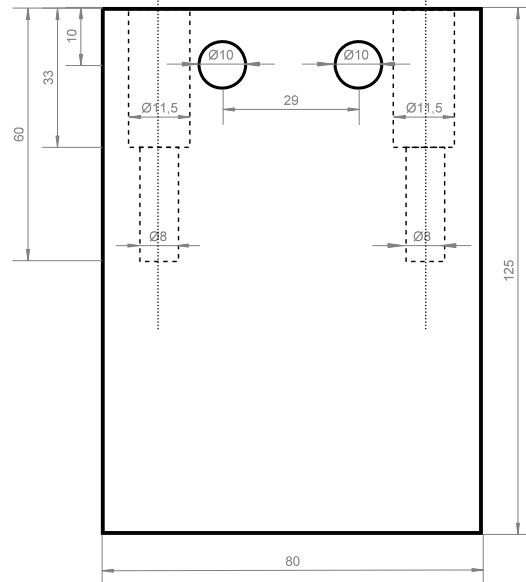

3

4

Änderungen		Datum	Name	Bezeichnung: MyFretbender Dimensions	Blattzahl:
Datum	Name	gez.:			
		gepr.:			Blatt-Nr.:
		Bernd Brieskorn (2013) All measures in [mm].		Zeichnungs-Nr.:	5